

# 450nm/5W Multi-Mode Pigtailed Laser

## Dimensions

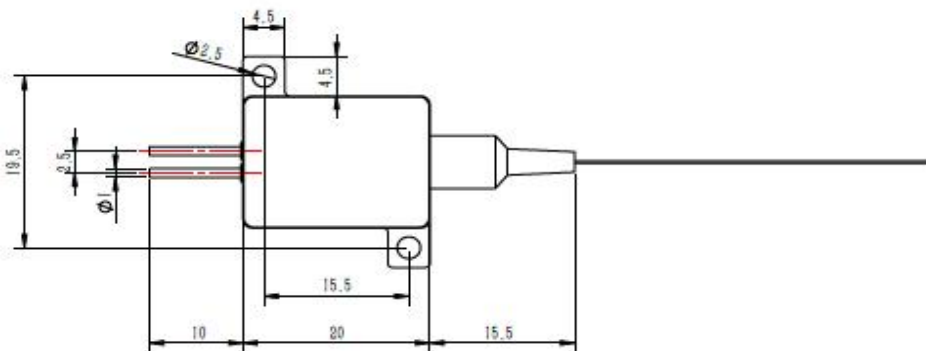
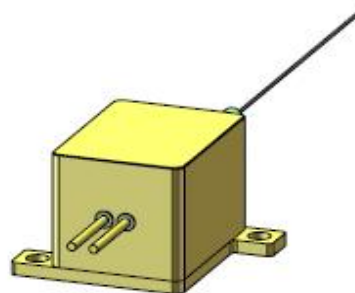
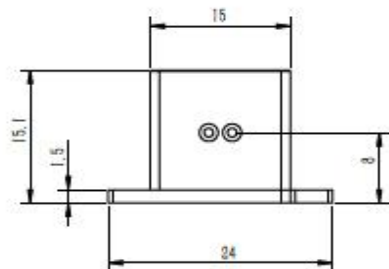

### Features:

- High output power
- Excellent beam quality
- High reliability

### Applications:

- Laser display
- Laser engraving
- Laser illumination

# 450nm/5W Multi-Mode Pigtailed Laser

## Specifications

Parameters	Min.	Typical	Max.	Test Conditions
<b>Optical Properties</b>				
Center Wavelength	445nm	450nm	455nm	At Po = 5000mW & Tcase = 25°C
Output Power ( <b>Pop</b> )		5000mW		At Tcase = 25°C, Iop = 3500mA
Operating Temperature ( <b>Tcase</b> )	-10°C	25°C	45°C	Using a base with good heat dissipation.
<b>Electrical Properties</b>				
Threshold Current ( <b>Ith</b> )		280mA	350mA	
Operating Current ( <b>Iop</b> )		3000(mA)	3500(mA)	At Po = 350mW & Tcase = 25°C
Operating Voltage ( <b>Vop</b> )		4.5V	5.5V	At Po = 5000mW & Tcase = 25°C
Reverse Breakdown Voltage ( <b>VR</b> )		1.8V		
<b>Fiber Type</b>				
Numerical Aperture (NA)		0.22		
Fiber Model	105/125			Customizable
Fiber Length	>1.0 m			Customizable
Ferrule Specifications	0.9 black loose tube			Customizable
Output Connector	Bare fiber or FC/APC			Customizable
<b>Storage Conditions</b>				
Storage Humidity	5% ~ 85% RH			No condensation
Storage Temperature	-20 ~ 60°C			No condensation